

Flat 6, 28 Aberdeen Road, Redland, Bristol, BS6 6HX

£195,000



- Period property
- Double bedroom
- Open plan kitchen
- Prime location
- Residents parking
- No onward chain

Hollis Morgan - A conveniently located 1 bedroom apartment situated in an attractive period building

Flat 6, 28 Aberdeen Road, Redland, Bristol, BS6 6HX

Accommodation

Description

Situated on the top floor of this imposing period terraced property this attractive flat comprises; open plan living room, modern kitchen, contemporary, shower room and double bedroom. An ideal first time purchase or buy to let investment.

Location

Aberdeen Road is located within a few yards of Whiteladies Road with its range of independent retailers, pubs, restaurants whilst the BBC, Bristol Royal Infirmary and University of Bristol are within a quarter mile.

Living Room /Kitchen

Built in washer/dryer, induction hob, oven, fridge with freezer box, laminate wood flooring, stone splash back tiles, electric radiator, original sash windows

Bedroom

Double bedroom with electric radiator, original sash windows

Bathroom

Heated towel rail, single electric shower and basin and WC

Tenure/ Management information

Management charge - £100 pcm (inclusive of ground rent)

Floor plan

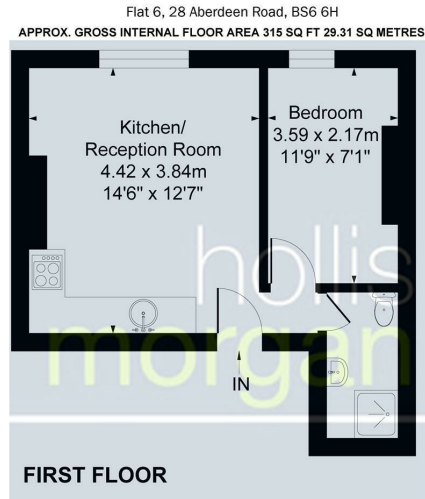

Illustrated for identification purposes only, measurements are approximate, not to scale.

EPC Chart

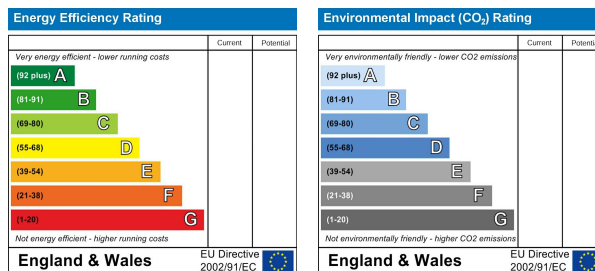

9 Waterloo Street
Bristol
BS8 4BT
Tel: 0117 973 6565
Email: sales@hollismorgan.co.uk
www.hollismorgan.co.uk

Hollis Morgan Property Limited, registered in England, registered 7275716.
Registered address, 5 Upper Belgrave Road, Clifton, Bristol BS8 2XQ